

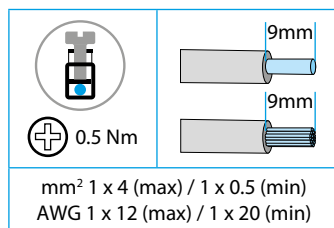

78.1B

IN	78.1B.1.230.2403 U_N (120...240)V AC (50/60 Hz) U_N 220 V DC $U_{min} - U_{max}$ 100 - 265 V AC (50/60 Hz) $U_{min} - U_{max}$ 140 - 275 V DC $P_{(stand-by)} < 1$ W
OUT	- [IN 230 V AC, (-20...+40)°C] 5 A (max 10 A - 5 ms) 24 V DC, 120 W - [IN (100...275)V, 40°C] 4.5 A (max 10 A - 5 ms), 24 V DC, 110 W
	(-20...+70)°C
IP20	



78	U_N	LED
OK	✓	
Sh	✓	15s. OFF
ThL	✓	OFF

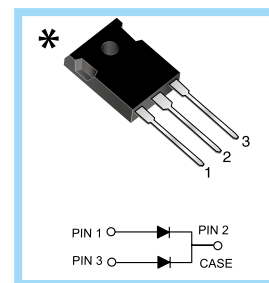
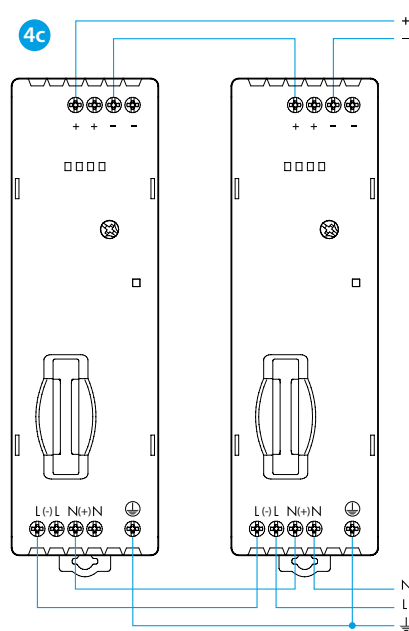
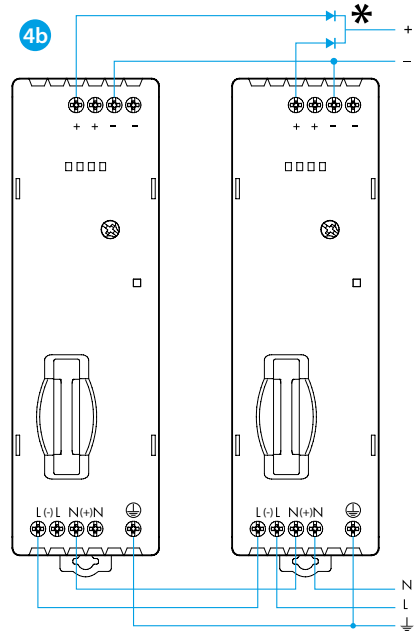
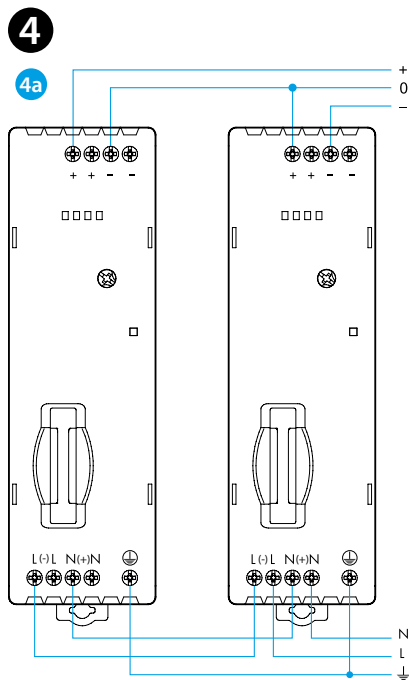
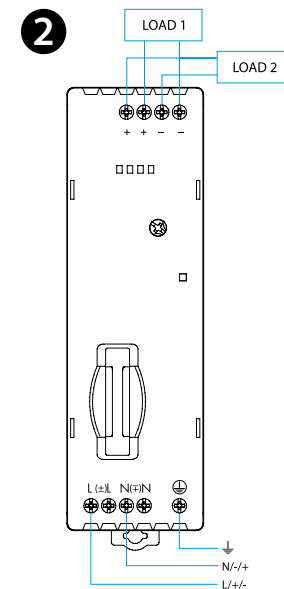
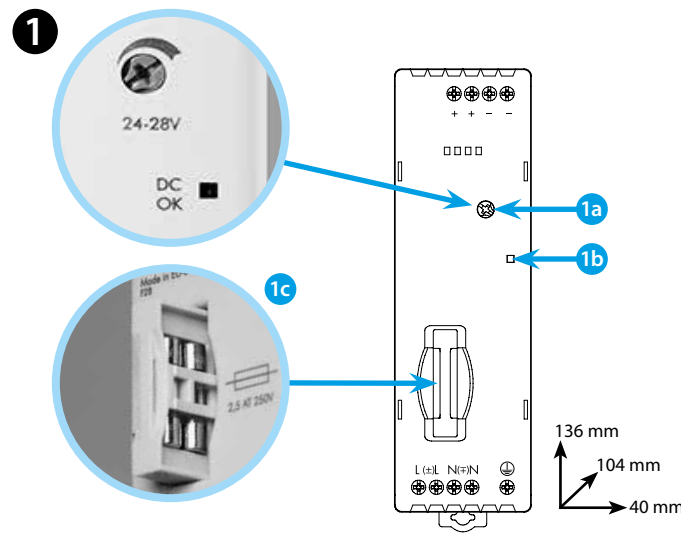

UL US LISTED
 IND. CONT. EQ.
 E361251
 Input 115 V AC 50/60 Hz / 1.65 A
 Output 24 V DC, 4 A / 96 W
 Input 230 V AC 50/60 Hz / 1.1 A
 Output 24 V DC, 4.5 A / 108 W

- Open Type Equipment - Pollution Degree-2 Installation Environment
- Maximum Surrounding Air Temperature 40°C
- Use 60°C / 75°C copper (CU) conductor and wire ranges No. 14-18 AWG, stranded or solid
- The terminal tightening torque of 0.5 Nm

A readily accessible disconnect device shall be incorporated in the building installation wiring:

- Circuit breaker 6 A Z-curve
- Input fuse 3.15 A - T - F1
- Equipment intended for installation in restricted access location

SLOVENSKY

78.1B SPÍNANÉ ZDROJE

1 ROZMERY / ČELNÝ POHLED

- 1a** Menovité napätie 24 V DC, nastaviteľný rozsah 24...28 V DC
- 1b** LED: výstupné napätie
- 1c** Interná poisťka na vstupe (vrátane náhradnej poisťky)

2 PRÍKLAD PRIPOJENIA

3 LED INDIKÁCIA

- U_N AC/DC napájanie
- Sh Skrat
- ThL Dosiachnutie teplotnej hranice
- Led (**1b**) LED zelená

4 PRÍKLAD PRIPOJENIA

- 4a** Sériové zapojenie ako symetrický zdroj
- 4b** Paralelné zapojenie pre automatické zálohovanie
* MBR 4060PT (TO247)
- 4c** Sériové zapojenie pre zvýšenie napätia

POZNÁMKA

- Účinnosť: 93% @ 230 V AC
- Automatická ochrana proti skratu